



**INSTALLATION INSTRUCTIONS
CANAM MAVERICK X3
FULL WINDSHIELD – VENT – TINTED UPPER VISOR
PART # 78-2310**

IMPORTANT NOTICES

READ AND UNDERSTAND THESE INSTRUCTIONS COMPLETELY BEFORE INSTALLATION TO AVOID INJURY TO YOURSELF, DAMAGE TO THE VEHICLE OR ACCESSORY.

- For proper installation, **TWO** people are required.
- Torque specifications must be followed when tightening bolts. Over-tightening any and/or all screws will cause cracks around mounting holes which is not covered by any warranty.
- As specified on carton label, once protective film on shields is removed, product cannot be returned.
- As specified on carton label, damage caused by packaging staples is not covered by warranty. All staples must be removed prior to removing product from carton.
- Failure to follow these installation instructions completely may void any warrantable components and result in product damage or personal injury.
- Do not use Loctite or any other similar fastener adhesive. These types of products react to plastics and cause cracking. Not covered by any warranty.
- Our windshields are made from the highest quality material providing optimum transparency and clarity. Blurriness and/or extrusion marks may or may not appear when looking through windshield from a wide, side-angle. This is normal for all extruded clear plastic materials.
- The application of improper cleaners, abrasive and/or dirty cleaning towels can severely damage the product. Failure to follow cleaning recommendation (provided herewith) may void any warrantable components.

DEALER

These instructions contain important information for future reference and must be given to the customer at time of purchase or upon completion of installation.

Parts List (parts available with kit only and not available separately)

ITEM	PART NAME	DESCRIPTION	QTY	
A	Windshield	CNC windshield cut-out made of 1/4" thick GE MR10 polycarbonate or equivalent	1	
B	Tinted upper visor	CNC upper visor cut-out made of 1/4" thick GE tinted polycarbonate or equivalent	1	
C	Vent assembly	Includes: 1 vent cover, 1 vent flap assembly, 1 rubber vent seal and 7 vent mounting screws	1	
D	Co-extruded SIDE bulb seal (1/4")	Includes: 57" Co-extruded SIDE bulb seal (1/4") / #77-95BS-SIDE [end user to cut to exact length]	1	
INSTRUCTION BAG	E	"SPIKE" Velcro straps 12"	"SPIKE" Velcro strap 12" with double buckle	2
	F	Foam cushion 1/16"	Included: 51" of 1" x 1/16" self-adhesive foam cushion [end user to cut to exact length]	1
	G	Foam cushion 1/8"	Included: 18" of 1" x 1/8" self-adhesive foam cushion [end user to cut to exact length]	1
	H	Flop clamp set	Includes: 2 flop clamps and 4 injected rubber pad spacers (1 7/8")	2
	I	Hardware	Includes: 4 philips truss head screws M6 x 20, 7 philips truss head screws M6 x 24, 18 plastic shoulder washers M6 and 7 locknuts M6	1

1. Installation

- a) Find a clean flat area where you can safely lay down the windshield (Item A). Partially remove the protective film on both sides and apply the co-extruded **SIDE** bulb seal (Item D) between windshield lower edge notches using manual pressure to ensure good adhesion and cut any excess.

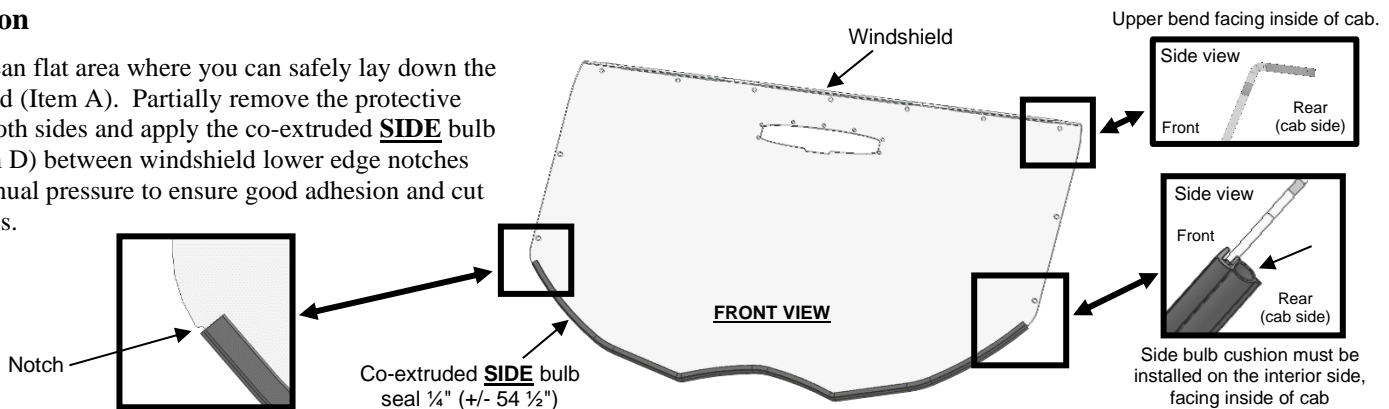

IMPORTANT NOTICES

Torque specifications must be followed when tightening bolts.

Over-tightening any and/or all screws will cause cracks around mounting holes which is not covered by any warranty.

b) **Vent assembly (Item C) installation:** Partially remove the protective film on both sides of the windshield around the vent cutouts and follow instructions below.

a. From the back side of the windshield, slide the vent flap assembly in the vent cut out as shown in image b1. Ensure the lower tab nests into the front of the windshield as shown in image b2 & b3.

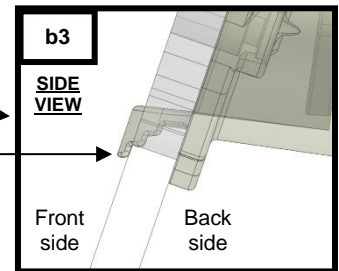
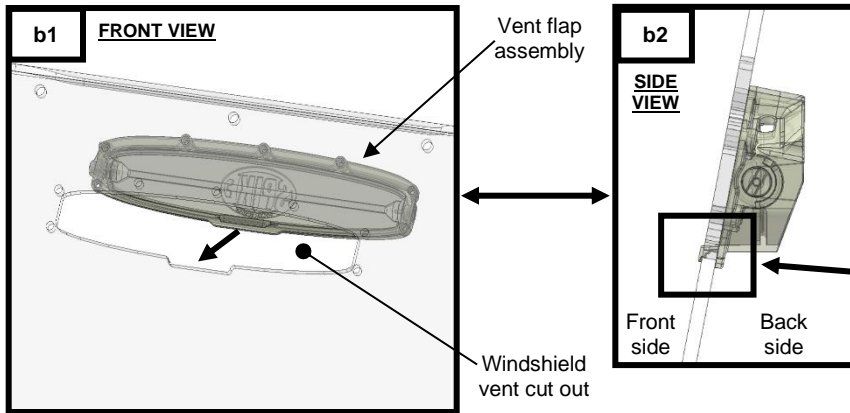
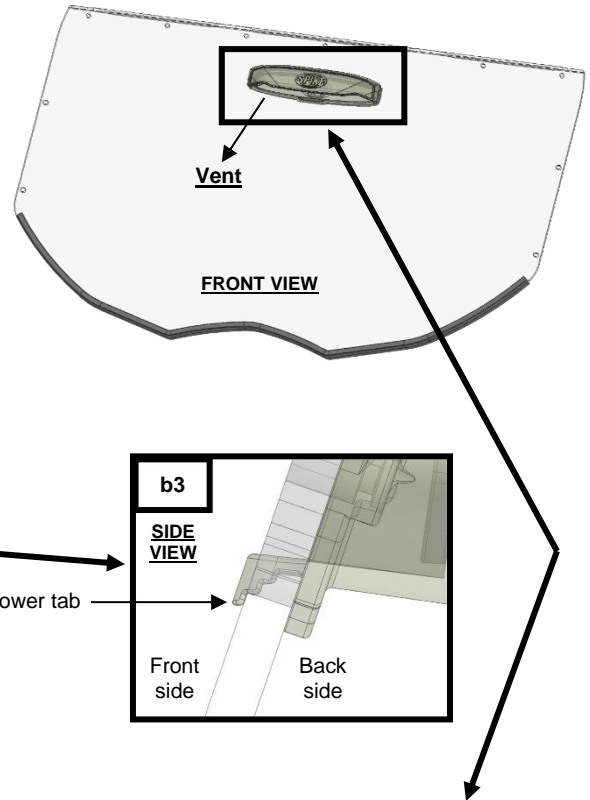

b. Install the remaining vent components (Item C) using supplied hardware as shown below in image b4 & b5.

Caution: over tightening any hardware could cause irreversible damage to the windshield.
DO NOT USE POWER TOOLS FOR THE INSTALLATION OF THE 7 MOUNTING SCREWS.

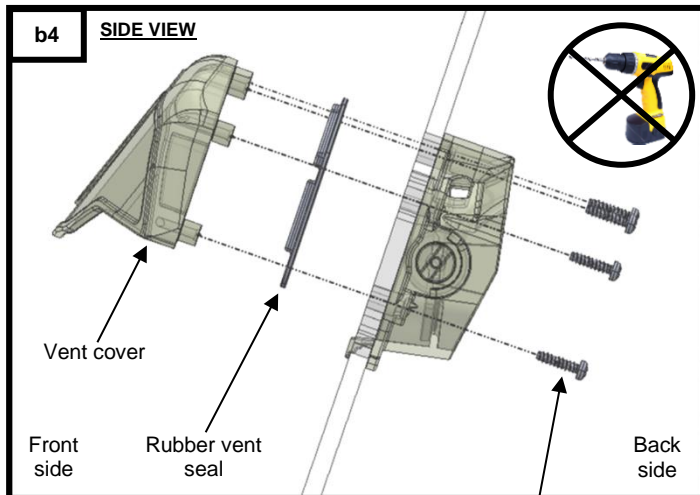
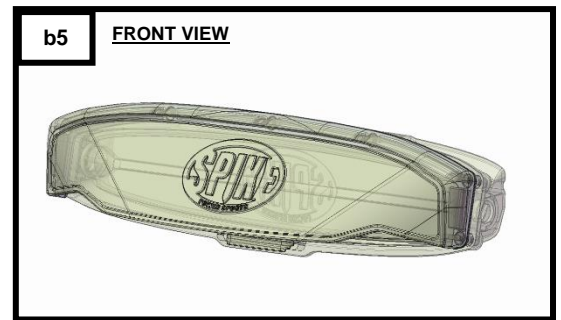

Vent mounting screws (7x)
 (2.0 ± 0.2 N•m / 18 ± 2 lbf•in)

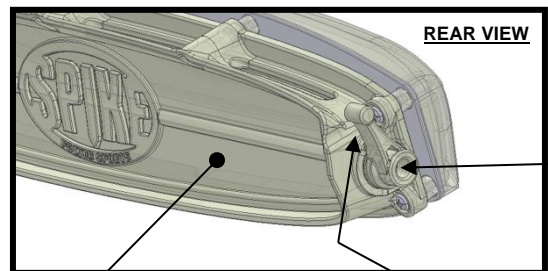

As shown on the rear-view image, the **lever** is installed by default on the right side of the vent. Lever can be installed/relocated on left or right side of the vent. End user can decide.

Tightening/Loosening of the **screw** in the lever determines the force required for the **baffle** adjustment.

IMPORTANT NOTICES

Torque specifications must be followed when tightening bolts.

Over-tightening any and/or all screws will cause cracks around mounting holes which is not covered by any warranty.

- c) Find a clean flat area where you can safely lay down the tinted upper visor (Item B). Partially remove the protective film on both sides and apply the self-adhesive foam cushion $\frac{1}{16}$ " (Item F) on the back side of the tinted upper visor as shown below. For proper installation, the surface must be free of any dust or any other contamination. Using a pen, screwdriver or any other similar pointy tool, pierce through the foam cushion using the tint upper visor mounting holes as guides (7 locations).

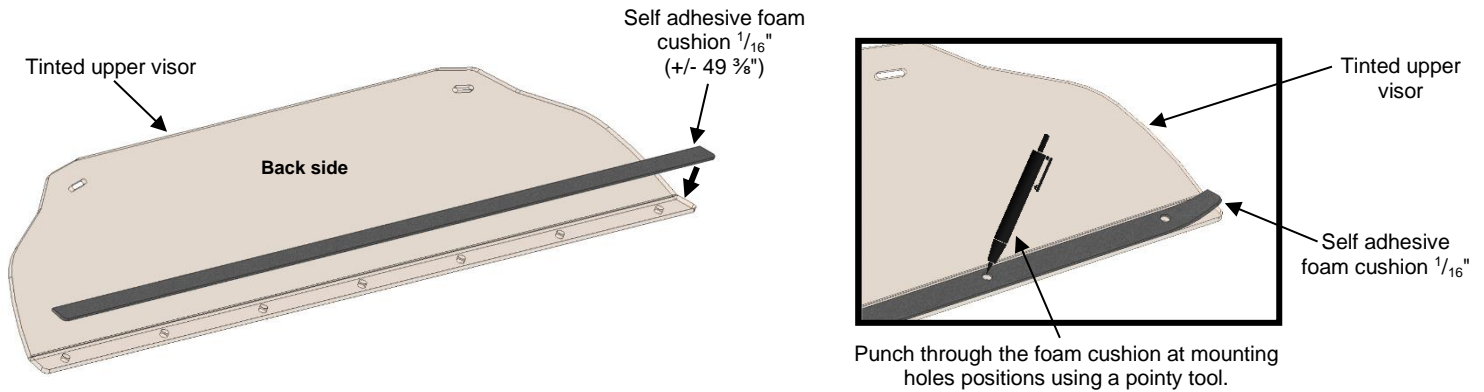

- d) Assemble the windshield and the tint upper visor together using supplied hardware (Item I) as shown below.

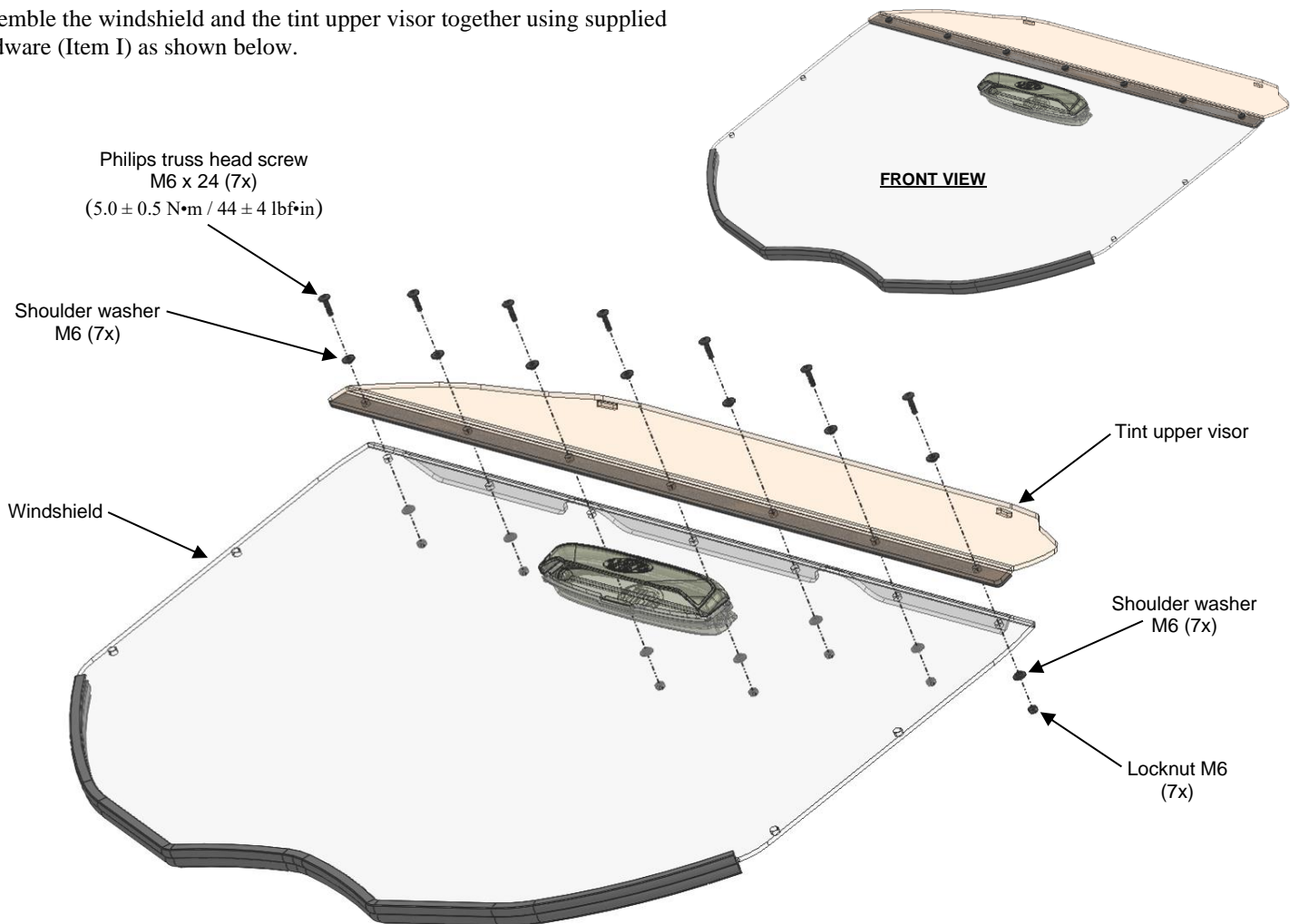

IMPORTANT NOTICES

Over-tightening any and/or all screws will cause cracks around mounting holes which is not covered by any warranty.

- e) Insert the injected rubber pad spacers (Item H) to all clamps as shown below.

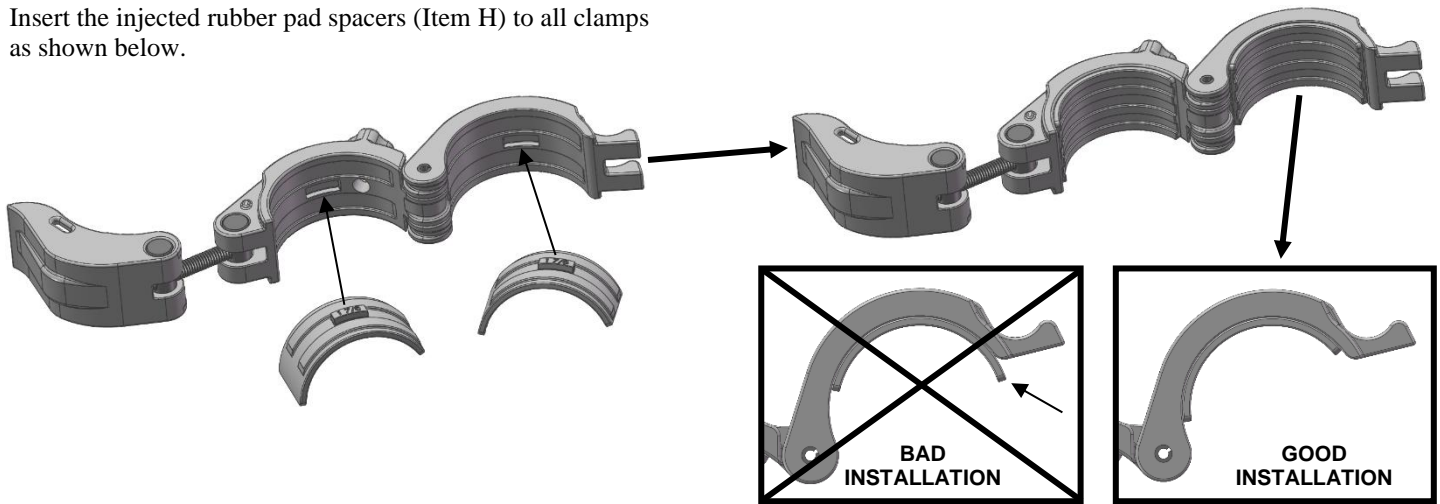

- f) Attach the clamps to the roll-cage as shown below and pre-adjust tightening tension of all clamps. **NOTE: Keep all clamp handles open as shown in step 3 below; this will allow you to move the clamps up or down when installing the windshield for the first time.**

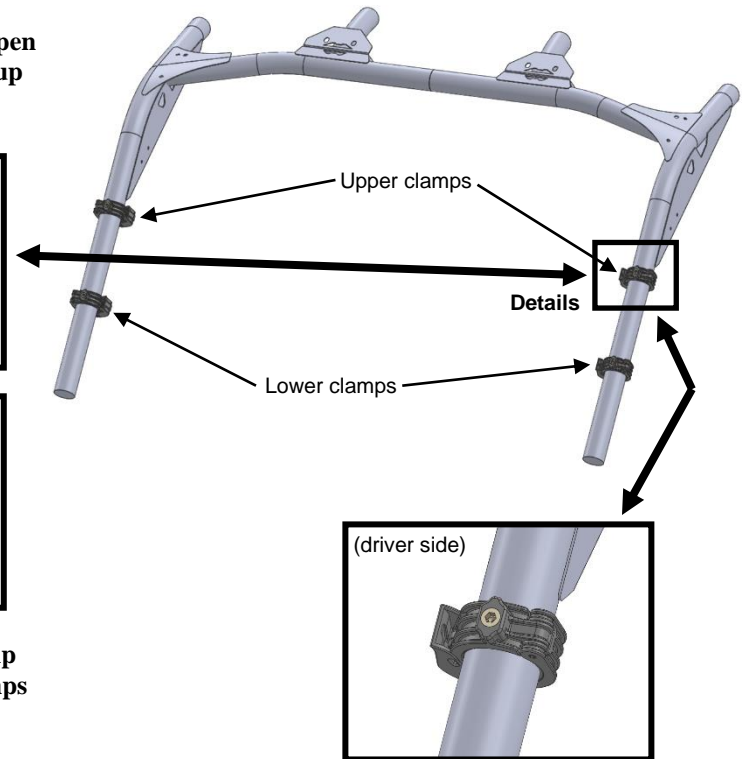
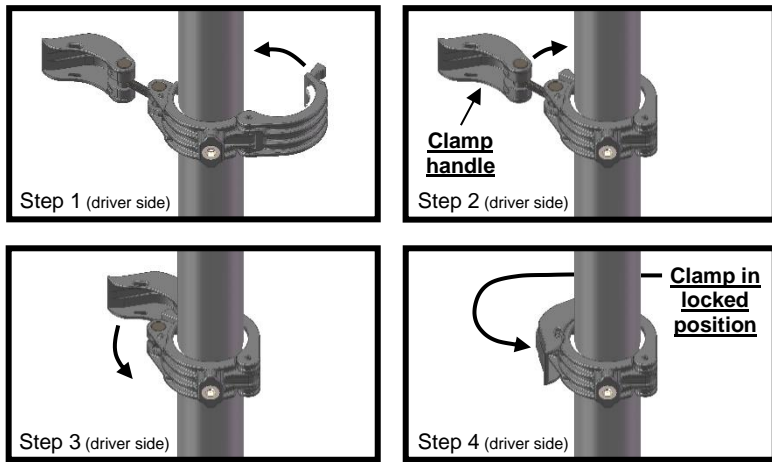

To apply more or less tension to the roll cage, simply rotate the clamp handle from the tension screw as shown below. Over tightening clamps to roll-cage could cause parts failures.

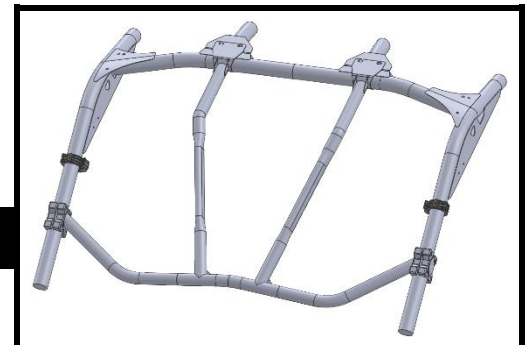
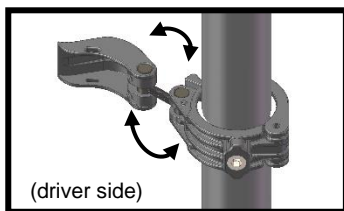

FOR INSTALLATION WITH OEM INTRUSION BARS

Only install both upper clamps. Lower clamps not needed

IMPORTANT NOTICES

Over-tightening any and/or all screws will cause cracks around mounting holes which is not covered by any warranty.

- g) Install the windshield to the clamps using supplied screws and washers (Item I) **without applying final torque.**

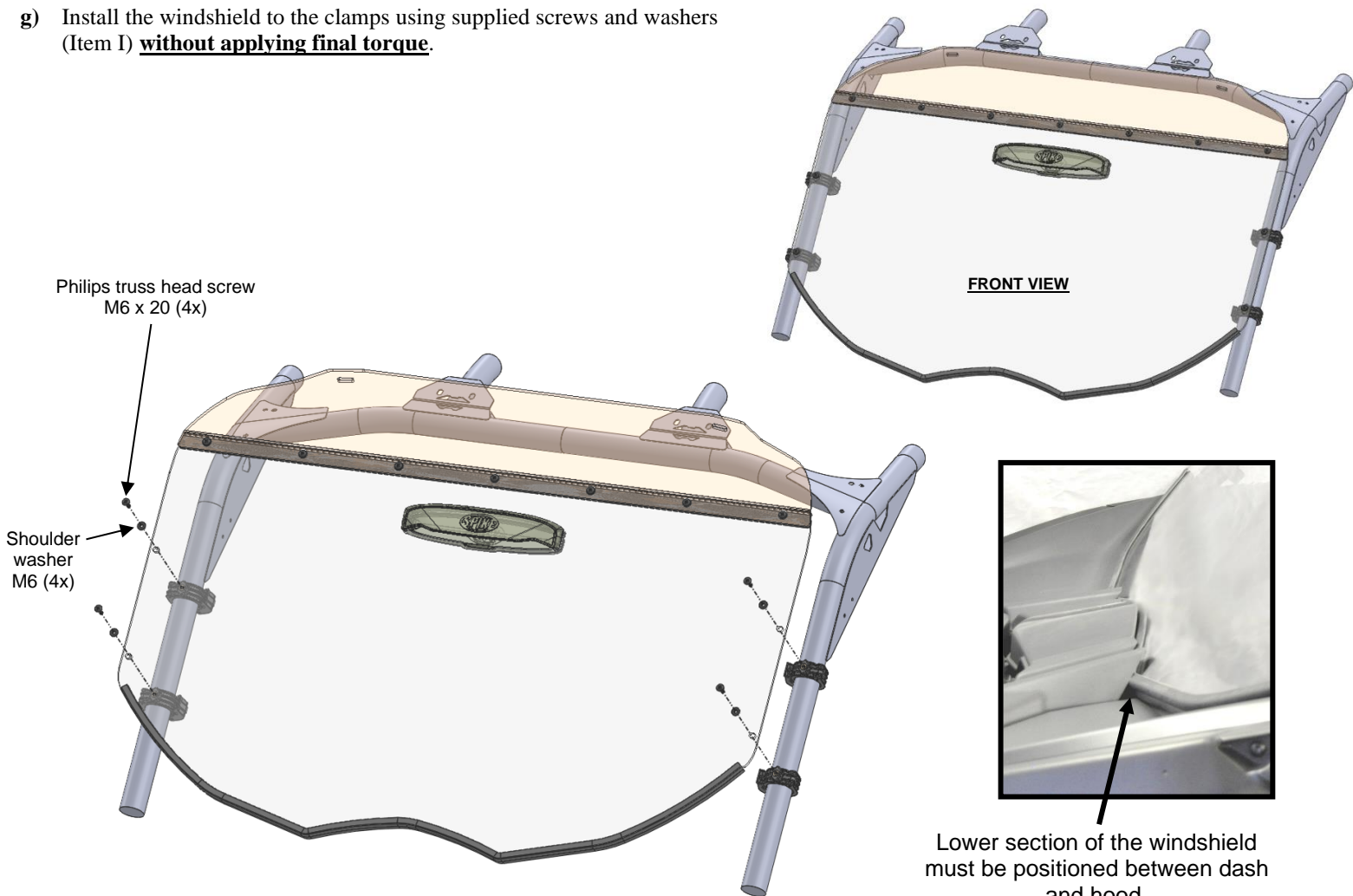

FOR INSTALLATION WITH OEM INTRUSION BARS

An additional self-adhesive foam cushion $\frac{1}{8}$ " (Item G) is supplied and must be added between the windshield and the OEM intrusion bar to prevent windshield from damage/scratches. As shown beside, locate the areas that require protection and apply the foam to the OEM intrusion bar, 2 sections of +/- 8" on each side should be enough.

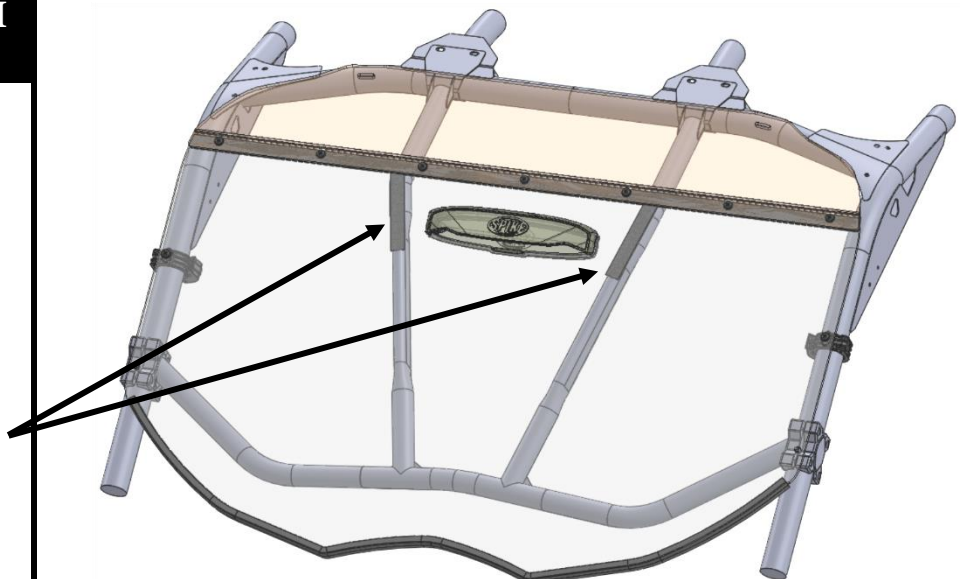

IMPORTANT NOTICES

Over-tightening any and/or all screws will cause cracks around mounting holes which is not covered by any warranty.

Velcro strap descriptions

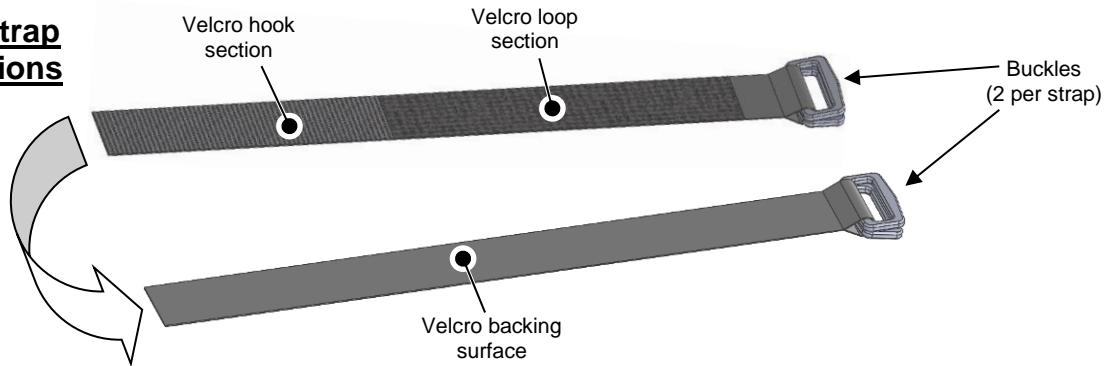

- h) Insert Velcro straps (Item E) in windshield upper slots with hook and loop section towards the front of the vehicle as shown below.

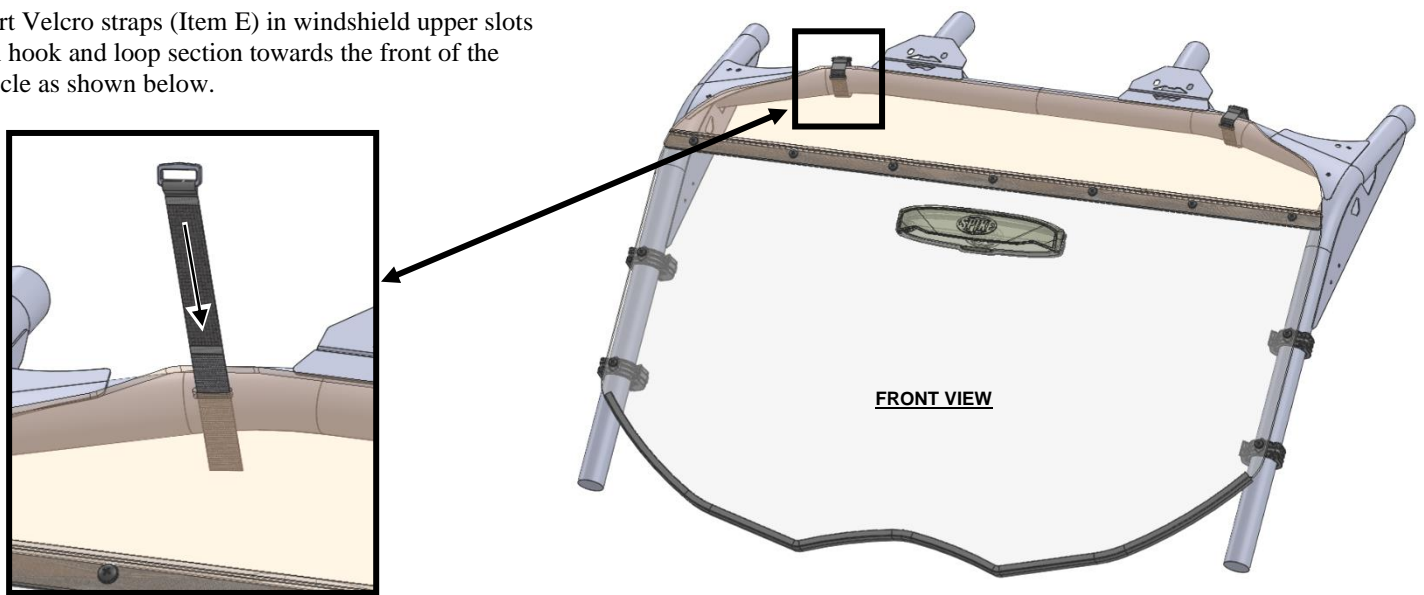

For all Velcro straps, wrap straps around the roll cage post and insert the strap into **both** buckles. Pull and secure Velcro hook and loop section together as shown below.

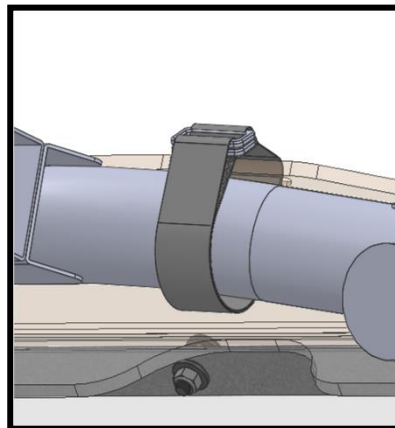
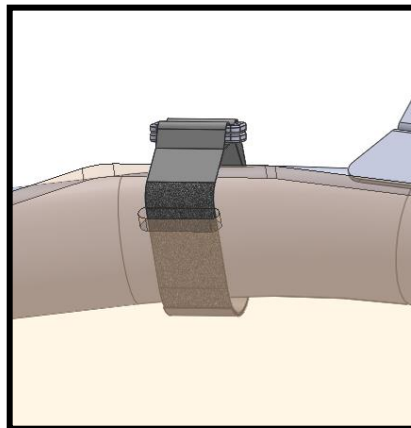
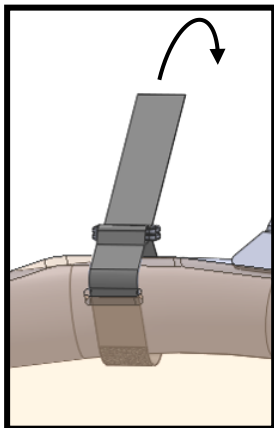

Same procedure for installation with OEM intrusion bars

IMPORTANT NOTICES

Torque specifications must be followed when tightening bolts.

Over-tightening any and/or all screws will cause cracks around mounting holes which is not covered by any warranty.

- i) Ensure that the windshield, Velcro straps and all clamps are properly positioned. Secure all clamps in locking position [Ref: Step 4 - section f] and tighten all hardware as shown below.

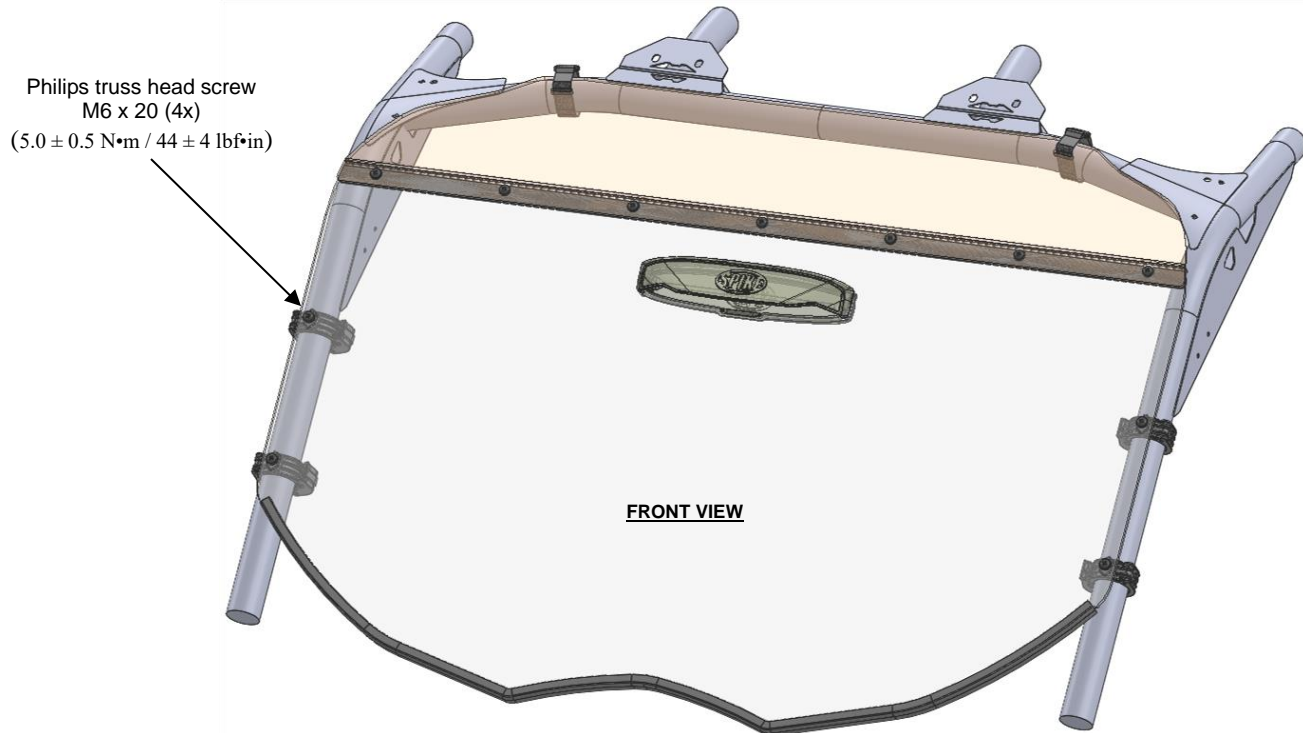

Same procedure for installation with OEM intrusion bars



CAUTION

Please understand that open trailer towing can result in windshield/roof damage due to high wind pressure and road debris. Towing at Highway Speeds (75+ mph) for EXTENDED periods (over 100 miles) causes constant and extreme pressure at the mount areas, and is not recommended. Spike suggests removal of roofs/windshields if towed in these conditions-removal will also create less drag on the tow vehicle. Lower speeds (60 mph) or two-lane roads are no problem.

2. Maintenance and Care

Tighten all hardware after first use and periodically thereafter.

CLEANING PROCEDURE: MR10 CLEAR WINDSHIELD

- Rinse with lukewarm water; wash gently with mild soap or detergent and lukewarm water, using a soft cloth or sponge. **DO NOT SCRUB** or use brushes or squeegees.
 - Rinse again. Dry with soft cloth or moist cellulose sponge to prevent water spotting.
- To remove wet paint, glazing compound or grease, rub lightly with a good grade of VM&P naphtha or isopropyl alcohol, then wash and rinse. **DO NOT USE GASOLINE.**

NOTICE: Abusive cleaning procedures by hand washing or automated washing equipment will eventually result in visual hazing, loss of light transmission and coating delamination.

Compatible Cleaning Agents

- Aqueous Solution of Soaps and Detergents

Fantastik | Joy | Formula 409 | Mr. Clean | Top Job | VM&P grade Naphtha | Hexcel, F.O. 554 | Neleco-Placer

CLEANING PROCEDURE: TINTED UPPER VISOR

- Rinse with lukewarm water; wash gently with mild soap or detergent and lukewarm water, using a soft cloth or sponge. **DO NOT SCRUB** or use brushes or squeegees.
 - Rinse again. Dry with soft cloth or moist cellulose sponge to prevent water spotting.
- To remove wet paint, glazing compound or grease, rub lightly with a good grade of VM&P naphtha or isopropyl alcohol, then wash and rinse. **DO NOT USE GASOLINE.**

NOTICE: Abusive cleaning procedures by hand washing or automated washing equipment will eventually result in visual hazing, loss of light transmission and coating delamination.

Compatible Cleaning Agents

- Aqueous Solution of Soaps and Detergents

Joy | Freon T.F. | Palmolive liquid | Top Job | VM&P grade Naphtha | Windex (with ammonia D)

MINIMIZING HAIRLINE SCRATCHES

For minimizing scratches and minor abrasions, mild automobile polish can be used.

Recommended products: Johnson Paste Wax, Novus Plastic Polish #1 and #2, Mirror Glaze plastic polish and Plexux1.

Testing polish on a separate Lexan sample is recommended. Be sure to follow product instructions carefully.