



**INSTALLATION INSTRUCTIONS  
KAWASAKI TERYX KRX 1000  
REAR WINDSHIELD - VENT  
PART # 78-8900A-R**

**IMPORTANT NOTICES**

**READ AND UNDERSTAND THESE INSTRUCTIONS COMPLETELY BEFORE INSTALLATION TO AVOID INJURY TO YOURSELF, DAMAGE TO THE VEHICLE OR ACCESSORY.**

- For proper installation, **TWO** people are required.
- Torque specifications must be followed when tightening bolts. Over-tightening any and/or all screws will cause cracks around mounting holes which is not covered by any warranty.
  - As specified on carton label, once protective film on shields is removed, product cannot be returned.
- As specified on carton label, damage caused by packaging staples is not covered by warranty. All staples must be removed prior to removing product from carton.
- Failure to follow these installation instructions completely may void any warrantable components and result in product damage or personal injury.
- Do not use Loctite or any other similar fastener adhesive. These types of products react to plastics and cause cracking. Not covered by any warranty.
- Our windshields are made from the highest quality material providing optimum transparency and clarity. Blurriness and/or extrusion marks may or may not appear when looking through windshield from a wide, side-angle. This is normal for all extruded clear plastic materials.
- The application of improper cleaners, abrasive and/or dirty cleaning towels can severely damage the product. Failure to follow cleaning recommendation (provided herewith) may void any warrantable components.

**DEALER**

**These instructions contain important information for future reference and must be given to the customer at time of purchase or upon completion of installation.**

**Parts List** (parts available with kit only and not available separately)

| ITEM            | PART NAME                    | DESCRIPTION   | QTY   |   |
|-----------------|------------------------------|---|---|---|
| A               | Upper windshield part        | CNC windshield cut-out made of 1/8" thick GE polycarbonate or equivalent                    | 1   |   |
| B               | Lower windshield part        | CNC windshield cut-out made of 1/8" thick GE polycarbonate or equivalent                    | 1   |   |
| C               | Vent assembly                | Includes: 1 vent cover, 1 vent flap assembly, 1 rubber vent seal and 7 vent mounting screws | 1   |   |
| D               | Co-extruded bulb seal (1/4") | Includes: 54" Co-extruded bulb seal (1/4") / #77-95BS [end user to cut to exact length]     | 1   |   |
| INSTRUCTION BAG | E                            | Velcro straps 12"   | Velcro strap 12" with double buckle   | 2 |
|                 | F                            | Flop clamp set  | Includes: 2 flop clamps and 4 injected rubber pad spacers (1 3/4")  | 2 |
|                 | G                            | Nuts & bolts  | Includes: 4 Philips truss head screws M6 x 16, 4 plastic shoulder washers M6, 7 push type retainers (5/16") and 4 round clamp spacers (1 1/2" long) | 1 |

**1. Installation**

- a) Insert the injected rubber pad spacers (Item F) to all clamps (Item F) as shown below.

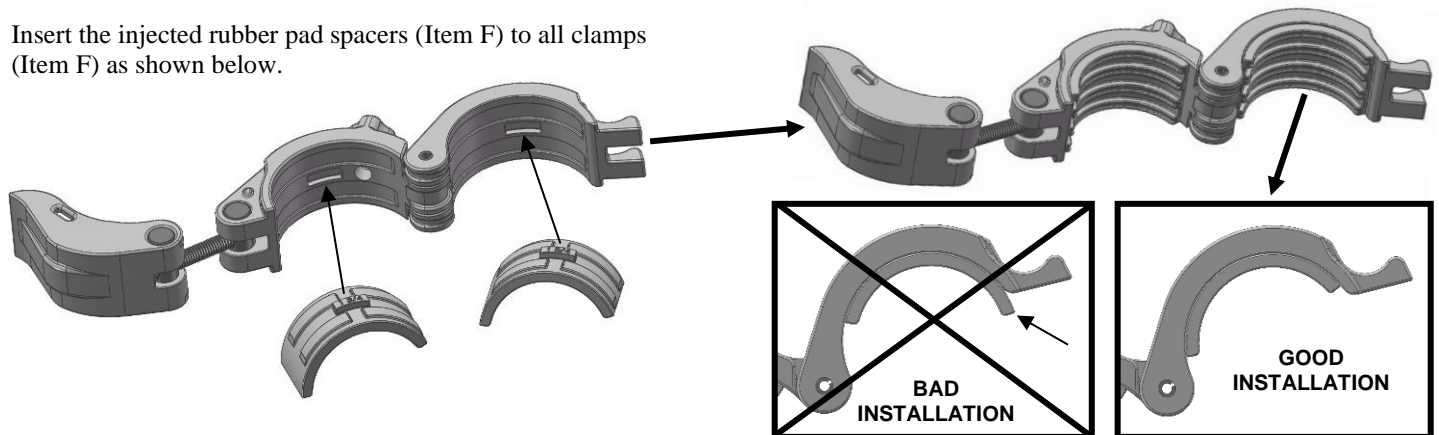

- b) Attach the clamps to the roll-cage as shown below and pre-adjust tightening tension of all clamps.  
**NOTE: Keep all clamp handles open as shown in step 4 below; this will allow you to move the clamps up or down when installing the windshield for the first time.**

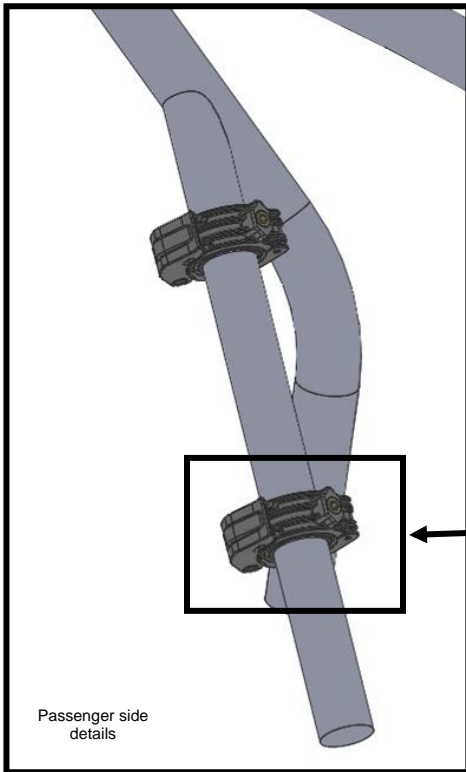
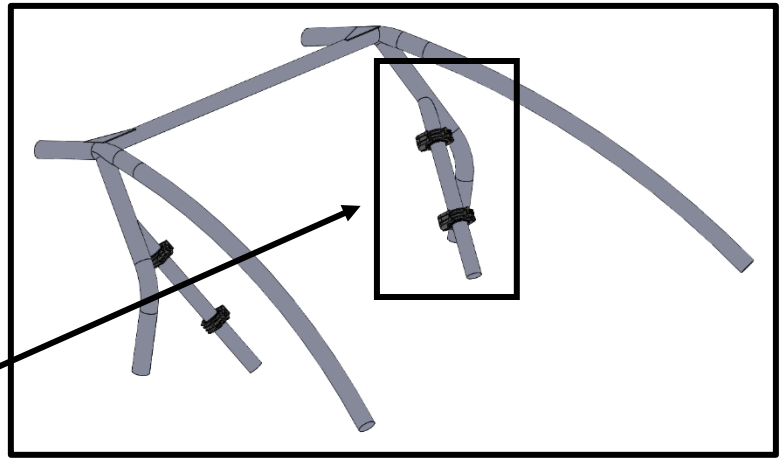

Round clamp spacers (1 1/8" long)  
**FOR ALL CLAMPS**

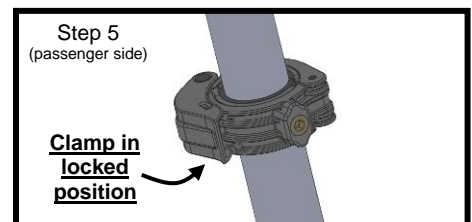
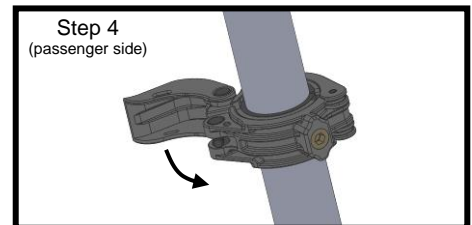
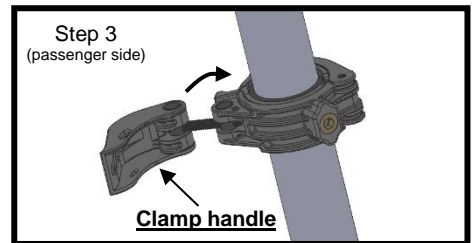
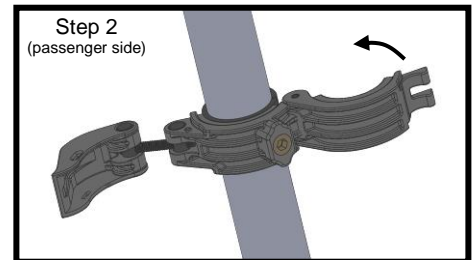
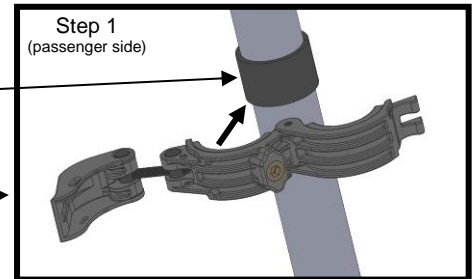

To apply more or less tension to the roll cage, simply rotate the clamp handle from the tension screw as shown below. Over tightening clamps to roll-cage could cause parts failures.

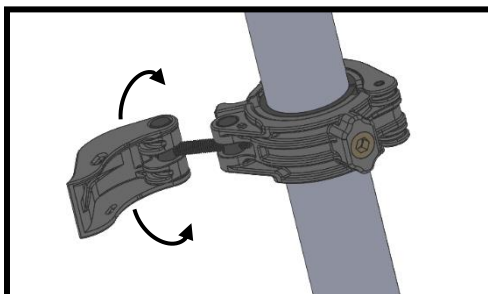

# IMPORTANT NOTICES

**Torque specifications must be followed when tightening bolts.**

**Over-tightening any and/or all screws will cause cracks around mounting holes which is not covered by any warranty.**

c) **Vent assembly (Item C) installation:** Partially remove the protective film on both sides of the upper windshield part (Item A) around the vent cutouts and follow instructions below.

1. From the front side (cab side) of the windshield, slide the vent flap assembly (Item C) in the vent cut out as shown in image b1. Ensure the lower tab nests into the front of the windshield as shown in image b2 & b3.

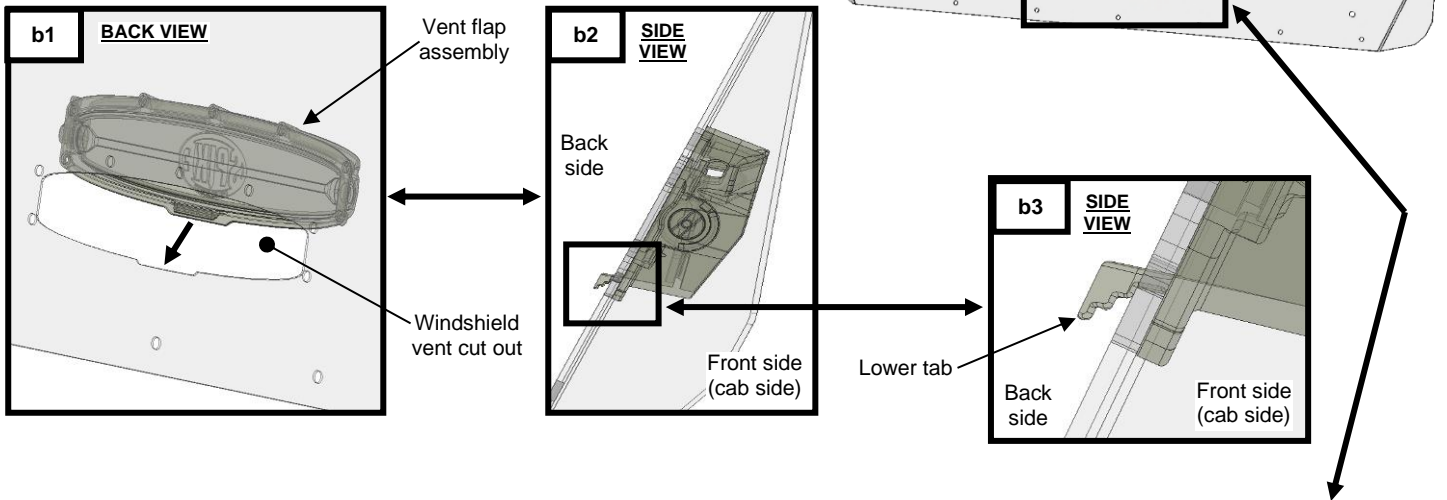

2. Install the remaining vent components (Item C) using supplied hardware as shown below in image b4 & b5.

**Caution: over tightening any hardware could cause irreversible damage to the windshield.**  
**DO NOT USE POWER TOOLS FOR THE INSTALLATION OF THE 7 MOUNTING SCREWS.**

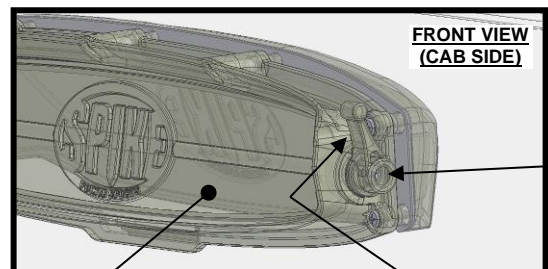
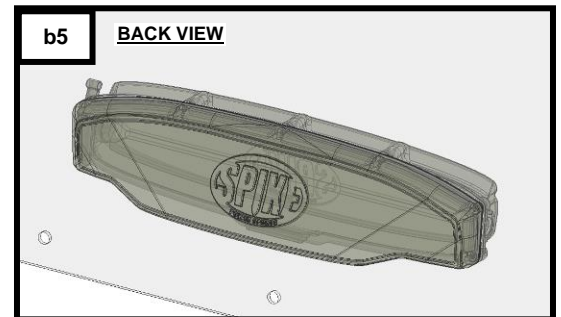
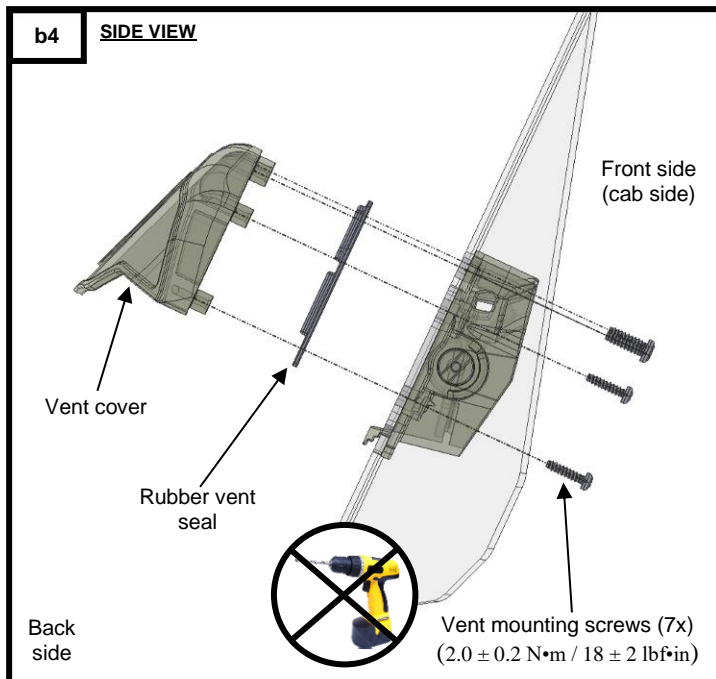

As shown on the front-view image, the **lever** is installed by default on the right side of the vent. Lever can be installed/relocated on left or right side of the vent. End user can decide.

Tightening/Loosening of the **screw** in the lever determines the force required for the **affle** adjustment.

## IMPORTANT NOTICES

Torque specifications must be followed when tightening bolts.

Over-tightening any and/or all screws will cause cracks around mounting holes which is not covered by any warranty.

## IMPORTANT NOTICES

**TWO people are required to install the rear upper windshield to the roll cage. Since windshield is wider than the space between the cage pipes, gentle manipulation and/or slight bending by each person will be required for windshield to slide into position.**

**Warning: Exercise extreme care during the next step in order to ensure that you do not damage the windshield or vehicle. This is a tight fit.**

- d) We strongly recommend adding extra protection (cardboard, towels ...) between the windshield and the vehicle at this step. This will protect both the windshield and vehicle against scratches during installation (**Do not remove protective film at this stage**). With two people, carefully slide the rear upper windshield (Item A) in place as shown below. Remove protective film and attach the windshield to the upper crossbar with Velcro straps (Item E) and to clamps using supplied screws and washers (Item G) without applying final torque. Ensure that the windshield and all hardware are properly positioned. Secure all clamps in locking position [Ref: Step 5 - section b] and tighten all screws/velcro straps as shown below. **Over-tightening clamps to roll bar could cause parts failures.**

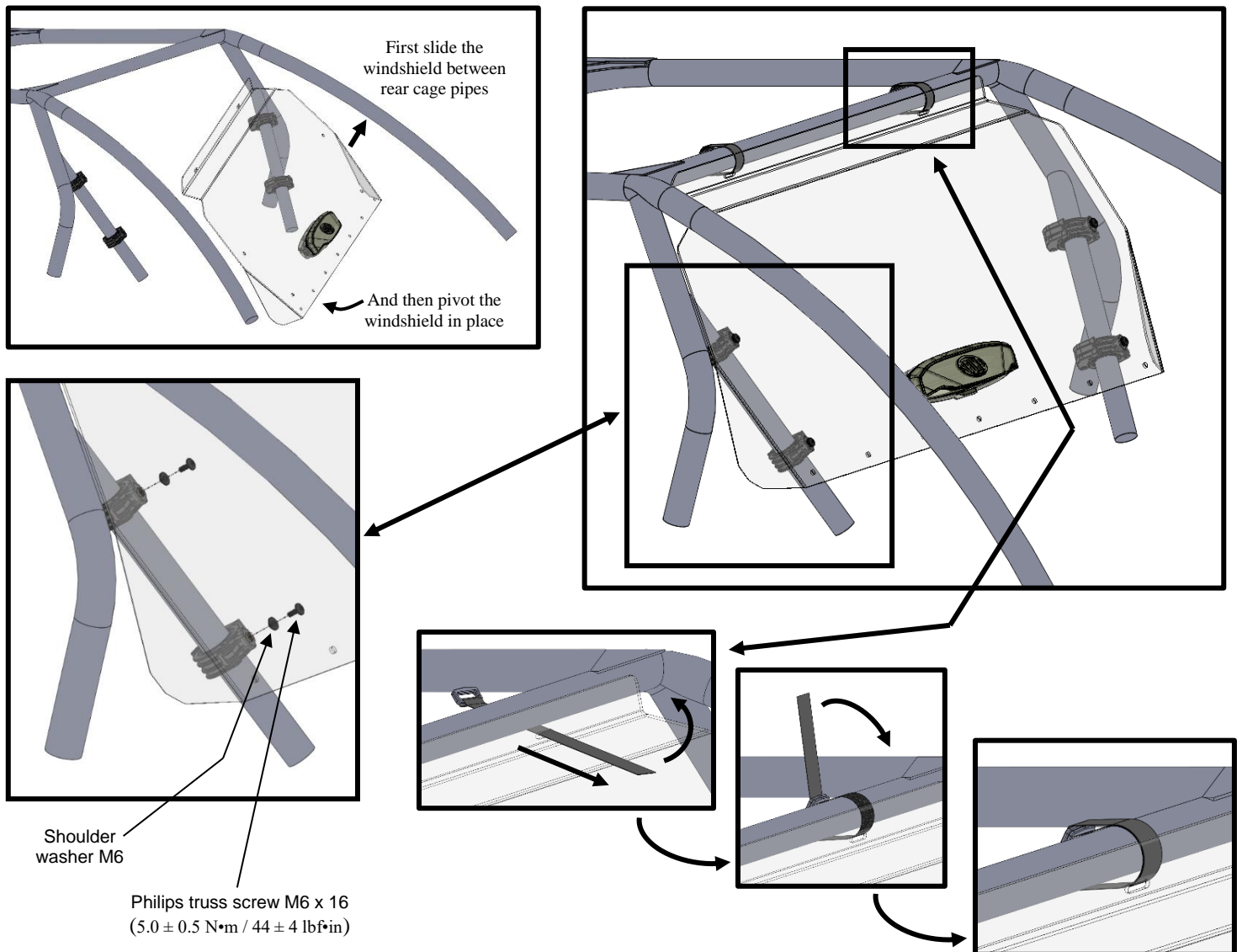

- e) Find a clean flat area where you can safely lay down the lower windshield part (Item B). Partially remove the protective film on both sides and apply the co-extruded bulb seal (Item D) to the lower lip and to the side lips using manual pressure to ensure it is properly and fully seated. Cut any excess.

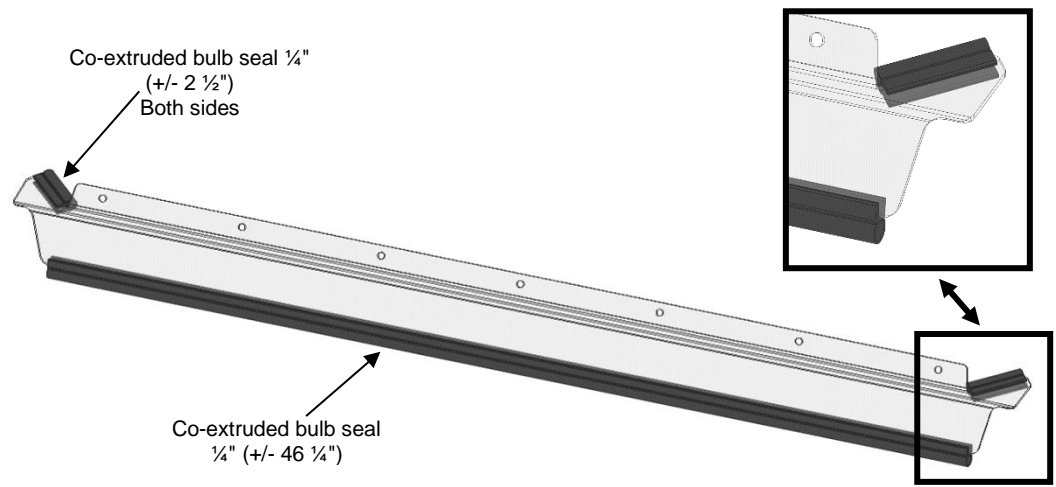

- f) Assemble the rear lower windshield part to the rear upper windshield part using supplied push type retainers (Item G) as shown below.

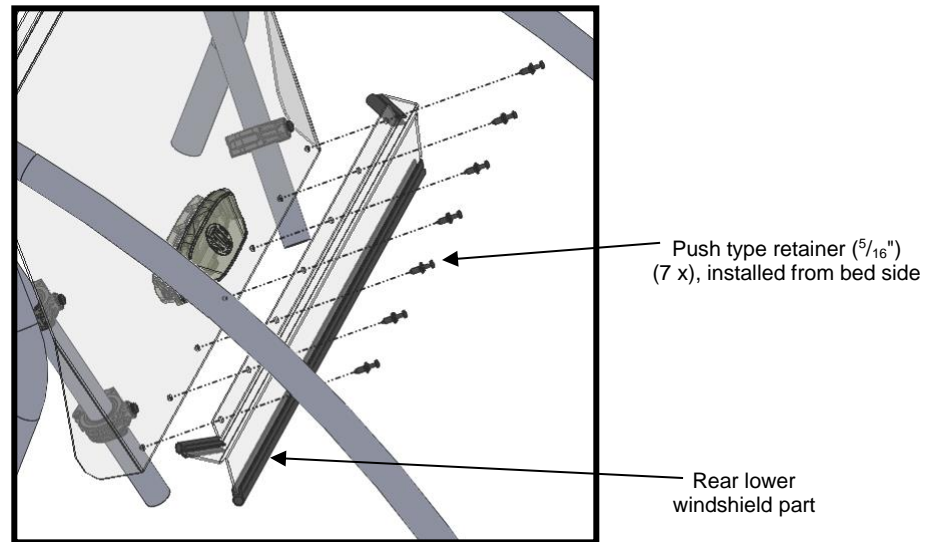

## IMPORTANT NOTICES

**Trailerable ONLY with a FULL Front windshield AND Roof - or damage can occur!  
Due to extreme wind turbulence, towing on an open trailer pulled by a motor home, bus  
or other large size vehicle at highway speeds is NOT recommended.**

## CAUTION

**Limited Towing at lower speeds (60mph or less) for shorter distances is acceptable with a  
FULL Front Windshield AND Roof ONLY. Prolonged towing at highway speeds on an  
Open trailer is NOT recommended and can cause damage that is NOT covered under  
Warranty. Whenever towing anytime, it is mandatory to check all windshield hardware  
BEFORE towing and at frequent intervals afterwards!**

**SPIKE suggests removal of Rear Windshields if towed in any conditions that are NOT  
recommended - removal will also create less drag on the tow vehicle**

## 2. Maintenance and Care

Tighten all hardware after first use and periodically thereafter.

### CLEANING:

- Rinse with lukewarm water; wash gently with mild soap or detergent and lukewarm water, using a soft cloth or sponge. **DO NOT SCRUB** or use brushes or squeegees.
  - Rinse again. Dry with soft cloth or moist cellulose sponge to prevent water spotting.
- To remove wet paint, glazing compound or grease, rub lightly with a good grade of VM&P naphtha or isopropyl alcohol, then wash and rinse. **DO NOT USE GASOLINE.**

**NOTICE:** Abusive cleaning procedures by hand washing or automated washing equipment will eventually result in visual hazing, loss of light transmission and coating delamination.

#### Compatible Cleaning Agents

- Aqueous Solution of Soaps and Detergents

----- Joy ----- Freon T.F. ----- Palmolive liquid ----- Top Job ----- VM&P grade Naphtha ----- Windex (with ammonia D) -----

### MINIMIZING HAIRLINE SCRATCHES

For minimizing scratches and minor abrasions, mild automobile polish can be used.

Recommended products: Johnson Paste Wax, Novus Plastic Polish #1 and #2, Mirror Glaze plastic polish and Plexux1.

Testing polish on a separate Lexan sample is recommended. Be sure to follow product instructions carefully.