



**INSTALLATION INSTRUCTIONS**  
**POLARIS RZR 4-900/RZR XP 4-1000**  
**ROOF**  
**PART # 88-4400**

**IMPORTANT NOTICES**

**READ AND UNDERSTAND THESE INSTRUCTIONS COMPLETELY BEFORE INSTALLATION TO AVOID INJURY TO YOURSELF, DAMAGE TO THE VEHICLE OR ACCESSORY.**

- For proper installation, **TWO** people are required.
- Torque specifications must be followed when tightening bolts. Over-tightening any and/or all screws will cause cracks around mounting holes which is not covered by any warranty.
- As specified on carton label, damage caused by packaging staples is not covered by warranty. All staples must be removed prior to removing product from carton.
- Failure to follow these installation instructions completely may void any warrantable components and result in product damage or personal injury.
- Do not use Loctite or any other similar fastener adhesive. These types of products react to plastics and cause cracking. Not covered by any warranty.

**DEALER**

These instructions contain important information for future reference and must be given to the customer at time of purchase or upon completion of installation.

**Parts List** (parts available with kit only and not available separately)

ITEM	PART NAME	DESCRIPTION	QTY
A	Front roof	Front roof made of 3/16" thick high dense polyethylene	1
B	Rear roof	Rear roof made of 3/16" thick high dense polyethylene	1
INSTRUCTION BAG	C	Optional seal Includes: 40" Co-extruded bulb seal (side bulb #260) [end user to cut to exact length]	1
	D	Flop clamp set Includes: 2 flop clamps, 2 rubber strip pads 3/32" and 2 rubber strip pads 3/16"	3
	E	Nuts & bolts Includes: 2 philips truss head screws M6 x 24, 11 philips truss head screws M6 x 20, 18 plastic shoulder washers M6 and 5 locknuts M6	1

**1. Installation**

- a) Remove the 2 upper OEM mounting screws from the roll cage OEM plastic visor as shown below and discard. **(Leave the OEM threaded clip nuts in place)**
- b) Temporarily loosen the 2 front OEM mounting screws from the roll cage OEM plastic visor as shown below. **(Do not remove them completely)**

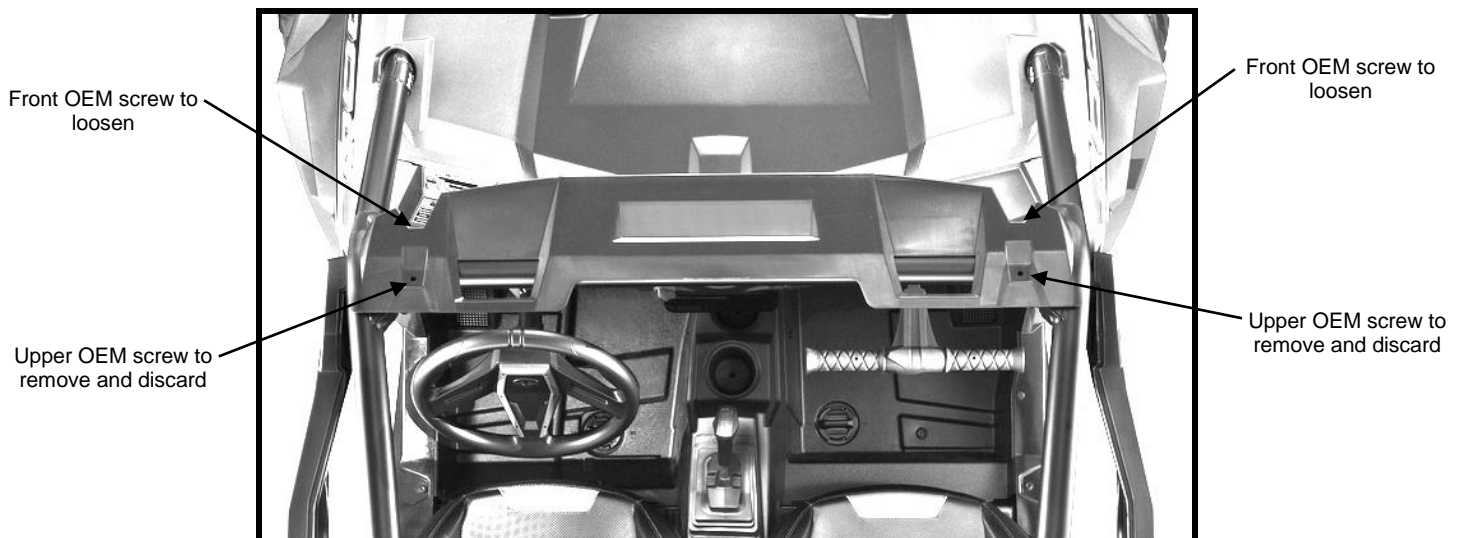

# IMPORTANT NOTICES

**Over-tightening any and/or all screws will cause cracks around mounting holes which is not covered by any warranty.**

- c) **Verify "Rubber strip" chart.** If required, peel and stick the rubber strips to clamps (Items D) as shown below. Different thicknesses of rubber strips are supplied with the clamp kits in order to fit multiple tube sizes. Make sure that the proper one is used. See chart indicating which rubber strip to use for the different tube sizes. **The roll-cage tube size of your vehicle is 1 3/4".**

ROLL BAR / ROPS DIAMETER	RUBBER STRIPS TO INSTALL
2" (2.000")	Not applicable
1 7/8" (1.875")	3/32" (0.094")
1 3/4" (1.750")	3/16" (0.188")

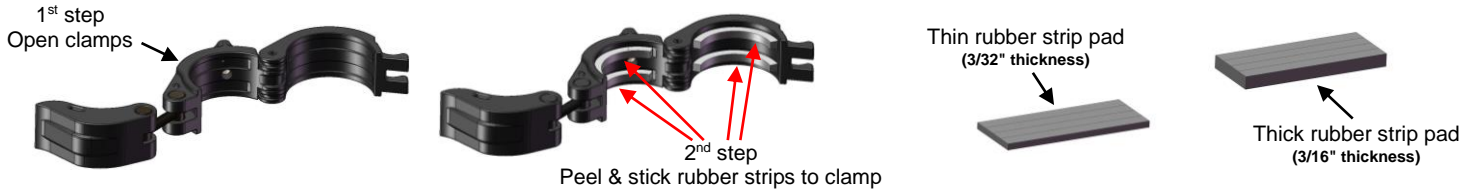

- d) Attach the clamps (Item D) to the roll-cage as shown below and pre-adjust tightening tension of all clamps. **NOTE: Keep all clamp handles open as shown in step 3 below; this will allow you to move the clamps when installing the windshield for the first time.**

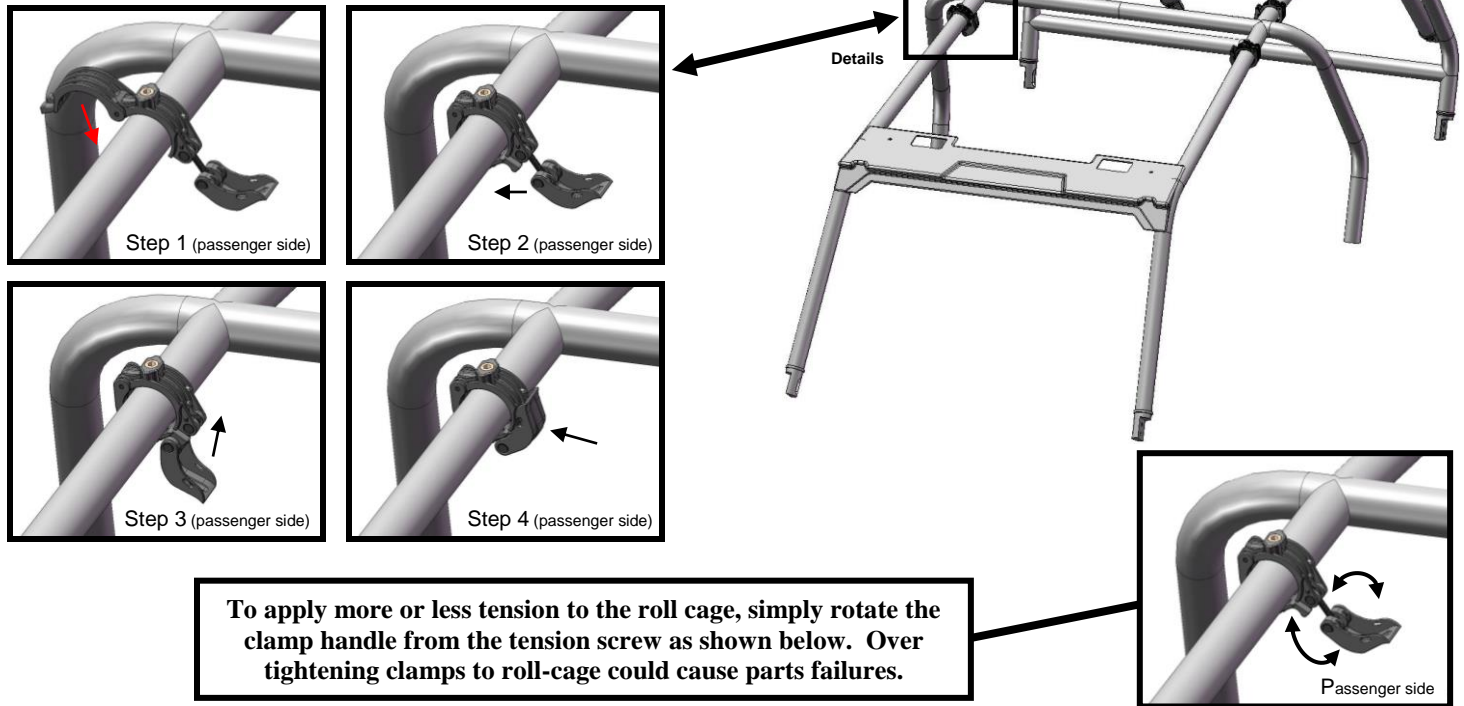

- e) Assemble the front and the rear roof (Item A & B) using supplied hardware (Item E) as shown below.

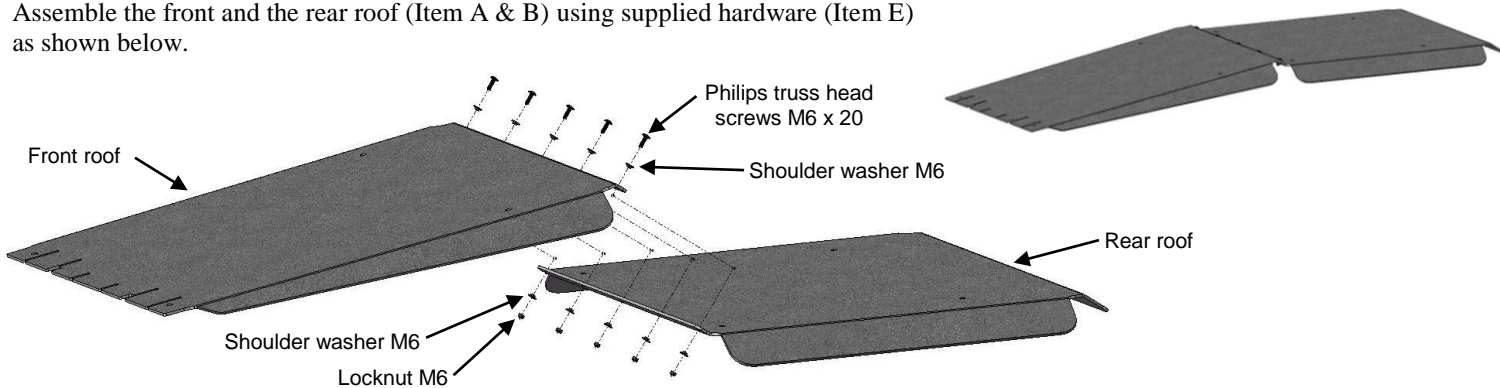

- f) **OPTIONAL ROOF SEAL (Item B) INSTALLATION.** Roof seal install may require snips to trim seal upon completion of installation. Use caution as seal has steel, and can be sharp on edges. Safety glasses & gloves should be worn.

Install seal prior to roof installation.  
Seal can be started from either side of visor.



# IMPORTANT NOTICES

**Over-tightening any and/or all screws will cause cracks around mounting holes which is not covered by any warranty.**

g) Install the front roof (Item A) and rear roof (Item B) to the vehicle using supplied hardware (Item D) as shown below and tighten.



1. Slide the front roof towards the front of the vehicle as shown on image A. The front roof must slide in between the OEM front visor and the roll cage so that the front edge of the roof touches the edge of the front visor at opening sections as shown on image B & C.
2. Secure both front and rear roofs in place using supplied hardware as shown on image D. Tighten all hardware, including the OEM mounting screws that have been loosened in step b.

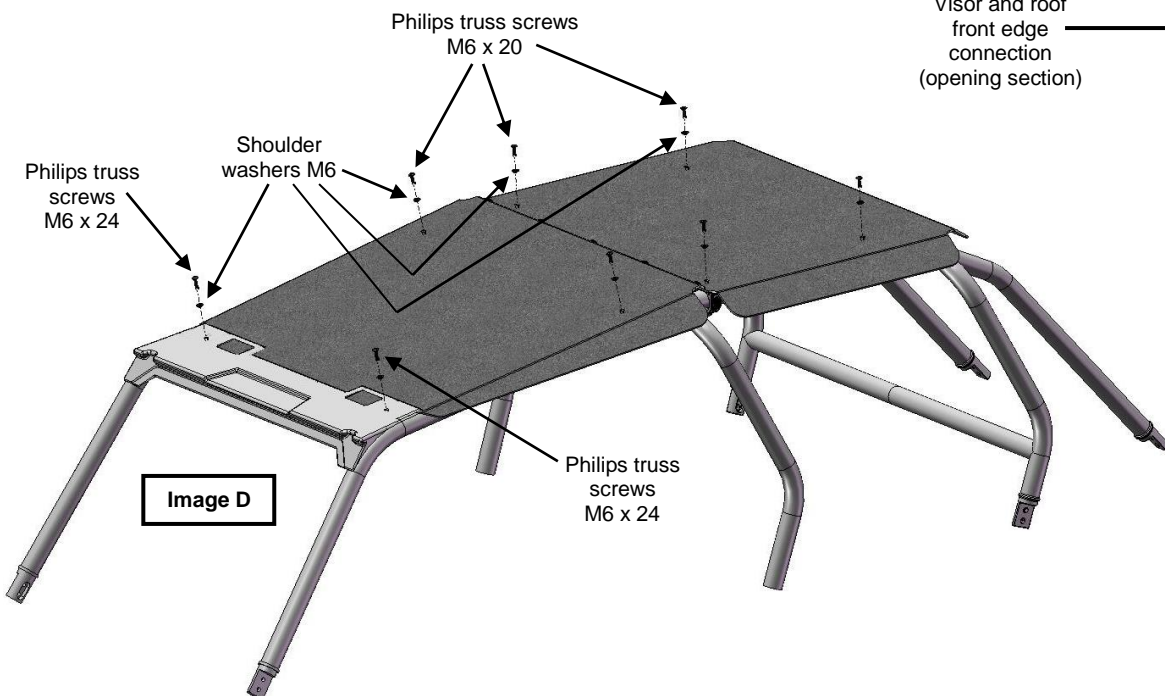
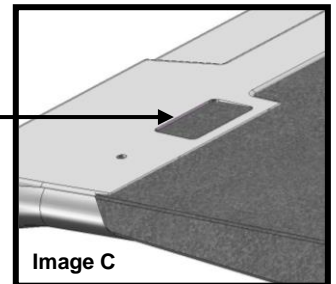
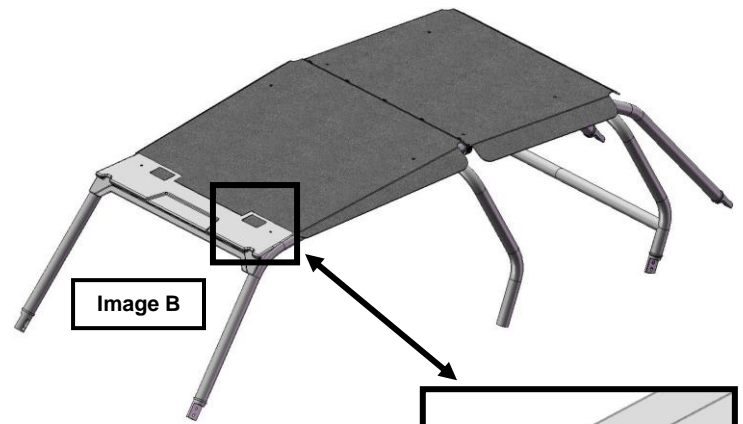
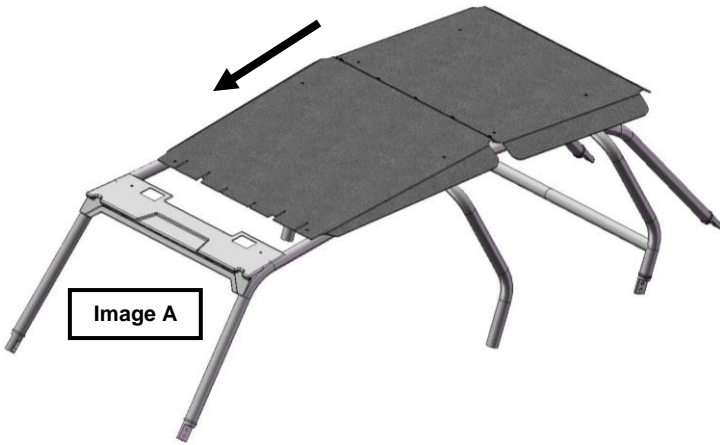

## 2. Maintenance and Care

Tighten all hardware after first use and periodically thereafter.